



EVERLIGHT ELECTRONICS CO.,LTD.

Device Number : CDDM-288-012 REV: 2

2.3" 8*8 Dot Matrix Displays

PATR NO. : ELM-2881EGWB ECN : Page: 1/5

■ Features :

- Large emitting dot 0.2" diameter.
- Low power/high brightness.

■ Applications:

- Instrument panels
- Digital read out display

■ Descriptions :

- The ELM-2881 series is a large emitting area(5.0mm diameter)LED sources configured in a 64 dots 8*8 matrix array.
- These devices are made with white dots and black surface.

PART NO.		Chip	
		Material	Emitted Color
ELM-2881EGWB	E	GaAsP/GaP	Orange
	G	GaP	Green

OFFICE : NO. 25,Lane 76,Sec.3, Chung Yang Rd., Tucheng 236, Taipei, Taiwan, R.O.C.

TEL : 886-2-2267-2000,2267-9936

FAX : 886-2-2267-6244,22676189,22676306

<http://www.everlight.com>



2.3" 8*8 Dot Matrix Displays

Package Dimensions:

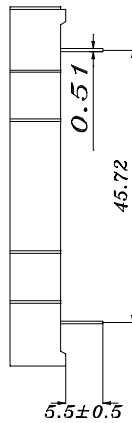
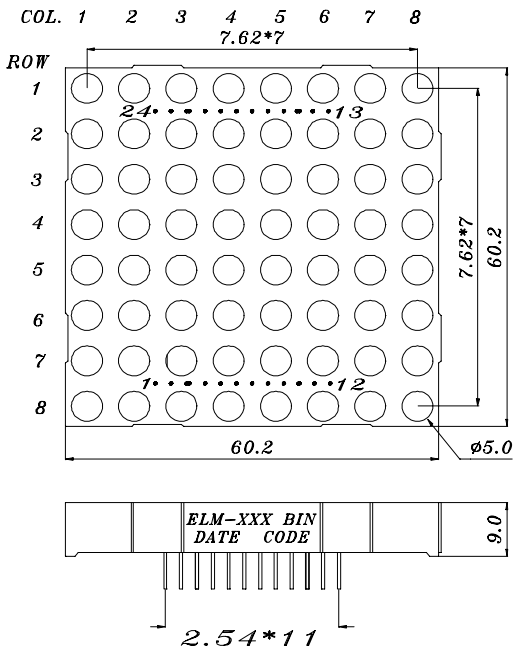

CATHODE COLUMN	
ANODE ROW	
1	CATHODE COLUMN 5(E)
2	CATHODE COLUMN 5(G)
3	ANODE ROW 5
4	CATHODE COLUMN 6(E)
5	CATHODE COLUMN 6(G)
6	ANODE ROW 6
7	CATHODE COLUMN 7(E)
8	CATHODE COLUMN 7(G)
9	ANODE ROW 7
10	CATHODE COLUMN 8(E)
11	CATHODE COLUMN 8(G)
12	ANODE ROW 8
13	ANODE ROW 4
14	CATHODE COLUMN 4(G)
15	CATHODE COLUMN 4(E)
16	ANODE ROW 3
17	CATHODE COLUMN 3(G)
18	CATHODE COLUMN 3(E)
19	ANODE ROW 2
20	CATHODE COLUMN 2(G)
21	CATHODE COLUMN 2(E)
22	ANODE ROW 1
23	CATHODE COLUMN 1(G)
24	CATHODE COLUMN 1(E)

E=RED G=GREEN

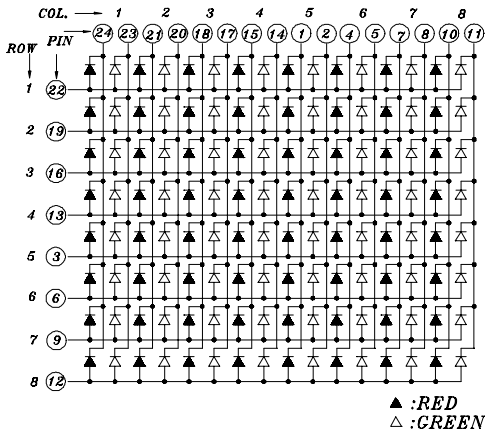

Notes :

- 1.All dimensions are in millimeters , tolerance is 0.25mm unless otherwise noted.
 - 2.Above specification may be changed without notice.
- Supplier will reserve authority on material change for above specification.



2.3" 8*8 Dot Matrix Displays

Typical Electro-Optical Characteristic Curves:

CHIP Material:GaAsP/GaP
Emitted Color:Hi-Eff Red/Orange

Spectrum Distribution
T_a=25°

Relative luminous intensity (%)

Wavelength λ_p(nm)

Forward Current vs. Forward Voltage

Forward Current I_f (mA)

FORWARD VOLTAGE(V_F)-volts

Forward Current Derating Curve

Forward Current I_f (mA)

AMBIENT TEMPERATURE T_a(°C)

GHIP Material:Gap
Emitted Color:Yellow Green

Spectrum Distribution
T_a=25°

Relative luminous intensity (%)

Wavelength λ_p(nm)

Forward Current vs. Forward Voltage

Forward Current I_f (mA)

FORWARD VOLTAGE(V_F)-volts

Forward Current Derating Curve

Forward Current I_f (mA)

AMBIENT TEMPERATURE T_a(°C)



EVERLIGHT ELECTRONICS CO.,LTD.

Device Number : CDDM-288-012 REV: 2

2.3" 8*8 Dot Matrix Displays

PATR NO. : ELM-2881EGWB ECN : Page: 5/5

■ Reliability test items and conditions:

NO	Item	Test Conditions	Test Hours/Cycle	Sample Size	Ac/Re
1	Solder Heat	TEMP : 260°C ± 5 °C	5 SEC	76 PCS	0/1
2	Temperature Cycle	H : +85°C 30min ∫ 5 min L : -55°C 30min	50 CYCLE	76 PCS	0/1
3	Thermal Shock	H : +100°C 5min ∫ 10 sec L : -10°C 5min	50 CYCLE	76 PCS	0/1
4	High Temperature Storage	TEMP : 100°C	1000 HRS	76 PCS	0/1
5	Low Temperature Storage	TEMP : -55°C	1000 HRS	76 PCS	0/1
6	DC Operating Life	IF = 10 mA	1000 HRS	76 PCS	0/1
7	High Temperature / High Humidity	85°C/85% RH	1000 HRS	76 PCS	0/1

